

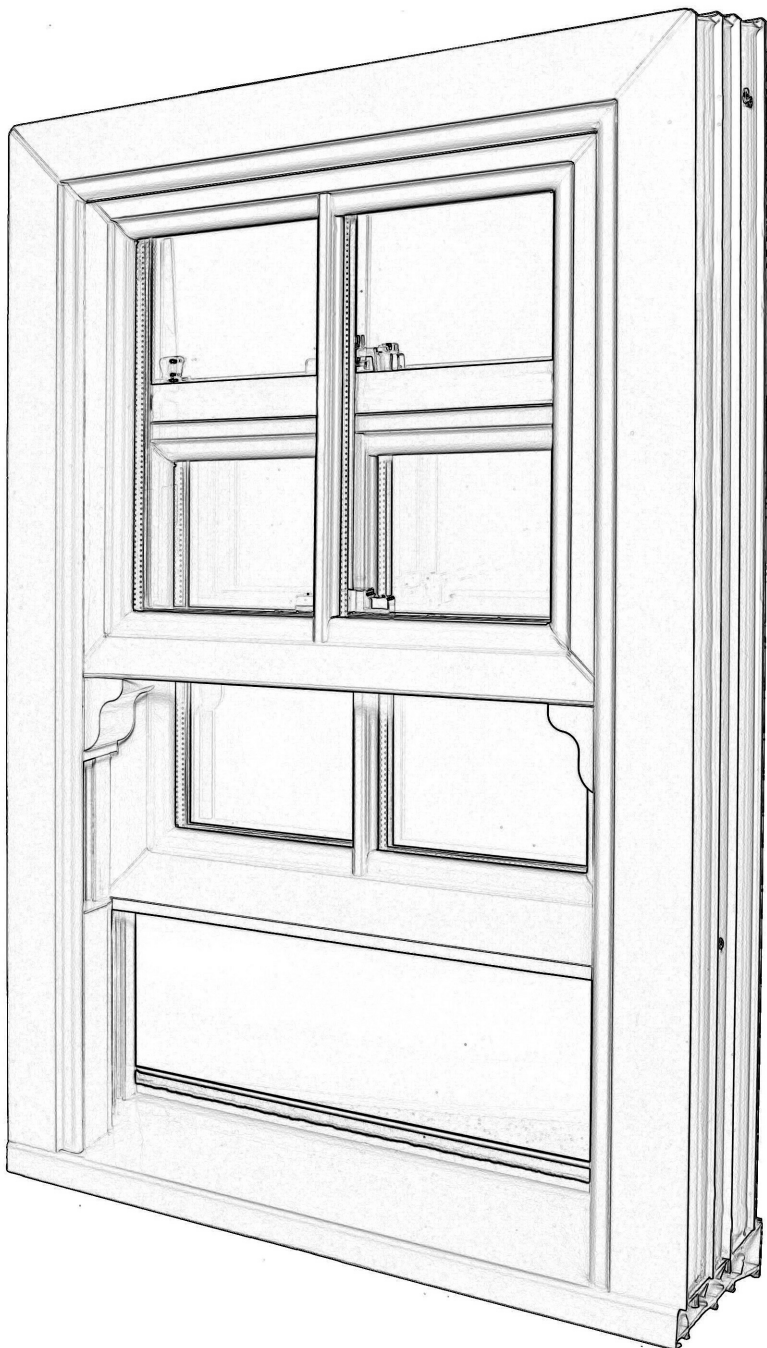

Vertical Slider INSTALLATION GUIDE



Measuring Guide

There are mainly two different ways in which windows will be originally installed



BRICK to BRICK

You will see about 20-40mm of visible brick showing on the outside

HOW TO MEASURE

Measure between the external brickwork opening and deduct 10mm both in width and height.

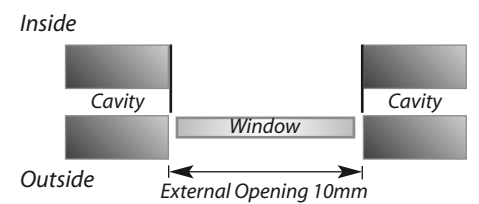

CHECK REVEAL
 Full width of the brick visible on the outside.

HOW TO MEASURE

Measure between the external brickwork opening add 40mm to the width and 20mm to the height with equal 20mm sitting behind the brick.

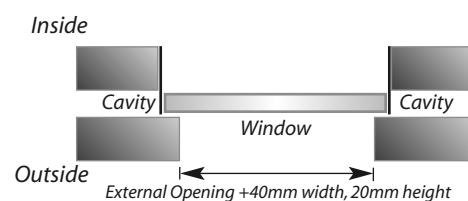

IMPORTANT
 Check the internal width and heights are larger than external

WINDOW REMOVAL



1

Cut the sash cords to the bottom sash, prise off internal staff bead – this enables you to remove the bottom sash

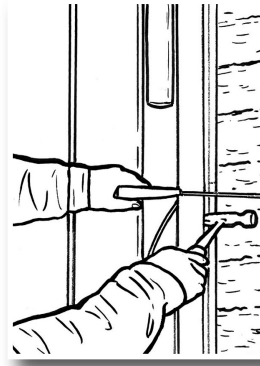

4

Cut the old box near to where you've removed the weights, taking care not to cut or damage any cables that may go through the window.



2

Cut the sash cords to the top sash, prise off the centre parting bead, the top sash can then be removed.



5

Once you've cut through the box, prise out sides trying not to cause damage to bricks, then remove head rail & sill.

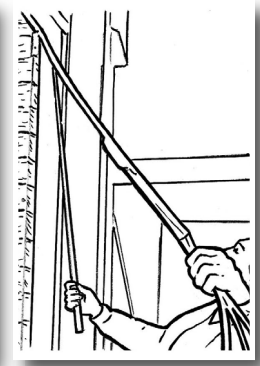

3

Remove the old sash weight as shown.

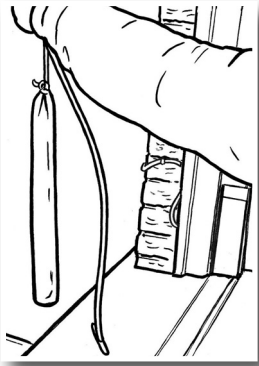

6

Once all the old wooden box has been removed, clean off any old cement or sealant that was around the old window.

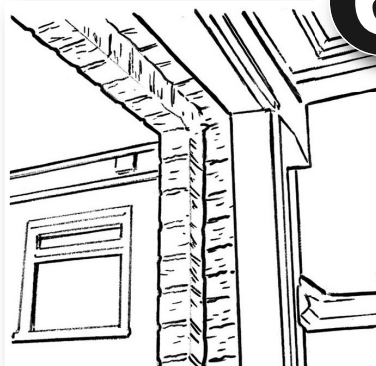

WINDOW INSTALLATION

It is vital when installing a sash window that you make sure it is fitted plumb and square. Ensure that the frame is not bowing inwards as this will make it impossible for the window to slide or tilt, likewise if the frame is bowing outwards then the window will be draughty.

1

Sill Packing

It's important to pack under the two corners of the sill directly below the jambs this then allows the dead load to be transferred directly to structure without bowing the sill. Failure to do this could result in the sill bowing upwards not allowing the locks to engage correctly.

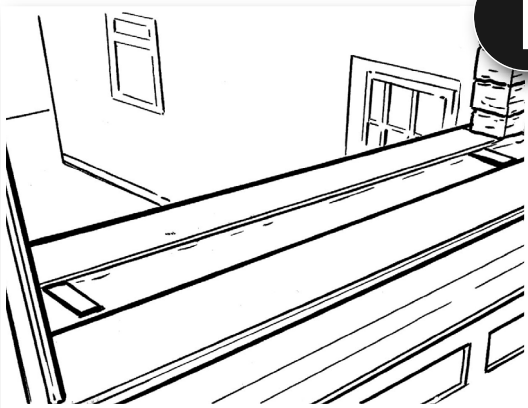

3

Installing

Lift the window into the opening making sure you get it plumb & square.

Fix through the brackets using suitable frame fixings ensuring you use packers to stop the frame bowing.



We strongly recommend not to use expanding foam to install the window as this may result in the frame bowing.

2

Fixing Brackets

Position the fixing brackets around the window no more than 150mm from the corners and no more than 600mm apart from each other

Fit the brackets across the top of the window to enable getting a secure fixing in the head, although brackets are the recommended form of fixing, it is also possible to remove the cover from the head and direct fix through it.

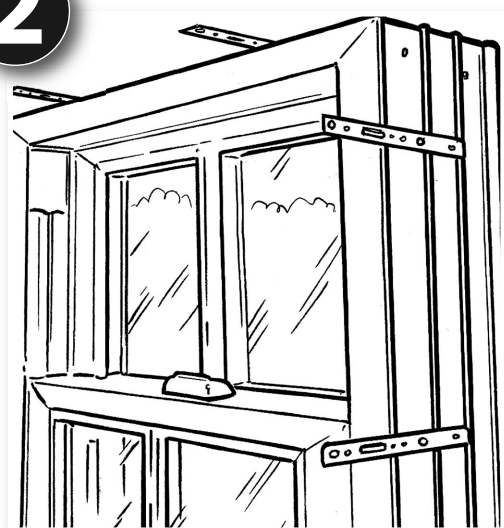

4

Making Good

Seal the outside of the window with a silicone sealant or sand and cement point if preferred. If the original timber linings are still in place bridge over the gap with a timber or pvc architrave.

If the linings have been removed then replace with new timber linings and architraves or make a timber frame cover in plasterboard and plaster,

